

The illustration above displays the wall mounting arrangement for the ST 3 loudspeaker and identifies the essential hardware supplied.

Components

- SRC-1 Clamp Assembly or W2C-1
- ST3 Loudspeaker
- Anchor bolts

ST 3 Wall Mounting

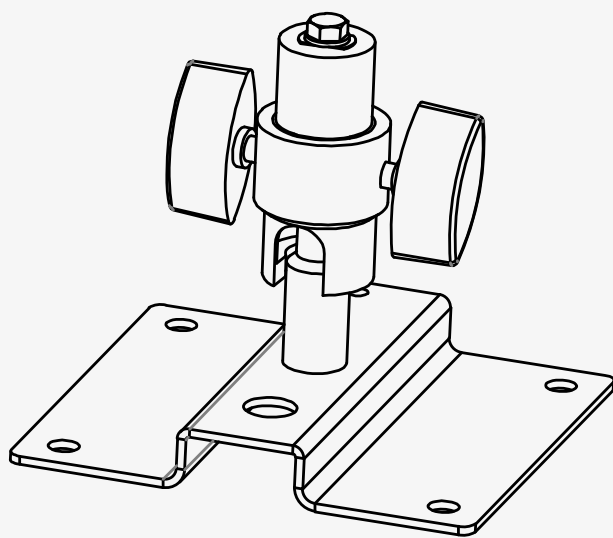

SRC-1
Clamp Assembly

OR

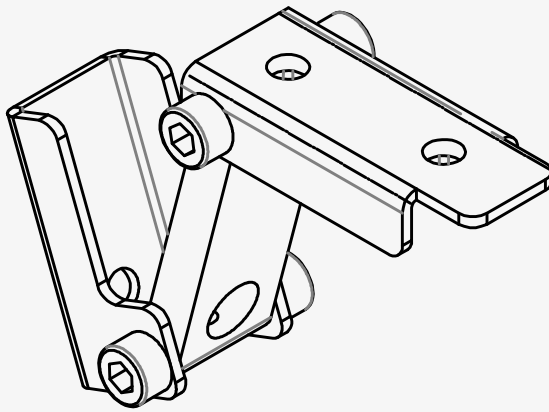

W2C-1
Clamp Assembly

Application Guidance

- o Fix the SRC-1 / W2C-1 to the ceiling using anchor bolts as shown in the diagram.
- o Attach SRC-1 / W2C-1 clamp assembly to the ceiling/ wall first.
- o Mount Loudspeaker on the SRC-1 / W2C -1 and tighten the fastener behind the loudspeaker.
- o Verify all joints before use.

This configuration ensures a stable, secure, and standards-compliant wall mounting for the ST 3 loudspeaker, showing all hardware placement and component relationships clearly.